

Powered by **OKIN**



BEDDING SYSTEMS

System Solutions for Bedding Applications

DEWERTOKIN TECHNOLOGY GROUP

DewertOkin Technology Group Ltd. is a subsidiary of Phoenix Meccano Group in Switzerland. Its two brands, Dewert and OKIN, are originated in North Rhine-Westphalia, Germany, counting over 40 years of history. With 5 production bases in Asia-Pacific and Europe, and a total of nearly 3,000 employees, DewertOkin provides integrated hardware and software solutions for Smart Home, Smart Healthcare, Smart Office and other scenarios.

- Smart Manufacturing
- Production Real-time Traceability
- Global Supply Chain
- Fast Delivery Guarantee



ONE-STOP SOLUTION FOR SMART FURNITURE

Under the brand OKIN you can find a wide range of products for smart furniture (such as motion upholstery, massage chairs, theatre seating, recliners and adjustable beds) and adjustable office desk and chair systems. Whereas the brand DEWERT offers high performance products for medical applications (such as medical and nursing beds).

The first in the industry to propose a One-stop Smart Solution concept, our company serves over 1/5 of the world's smart furniture manufacturers and is the preferred supplier of many world-class brands. with a presence in over 28 countries and regions around the world, DewertOkin is a true industry leader.



Over 40 years of experience

Over 40 years focusing on the development and innovation of One-stop Smart Solutions.
5 innovative R&D centers around the world with post-doctoral workstations as the core.
Over 1,500 patents, including more than 900 patents for inventions.



- In May 2021, we set up the first high-level national laboratory in the industry accredited by China National Accreditation Service for Conformity Assessment (CNAS).
- Awarded the National High-tech Enterprise Certificate & National IP Advantage Enterprise, and is the main drafting unit of the national light industry and Zhejiang manufacturing group standards.
- Approved by authoritative certification institutions.



One-Stop Solution for Motion Furniture



ACTUATOR
JLDQ.19

USB CHARGER SOCKET
PO.02



UNDERBED LED STRIP LIGHT
R5.113



MASSAGE MOTOR
MM.01.01



CONTROL BOX
CB.24.22



ACTUATOR
Deltadrive



POWER SUPPLY
PW.30



REMOTE CONTROL
RF.67



BLUETOOTH 5.0 CONTROL SYSTEM

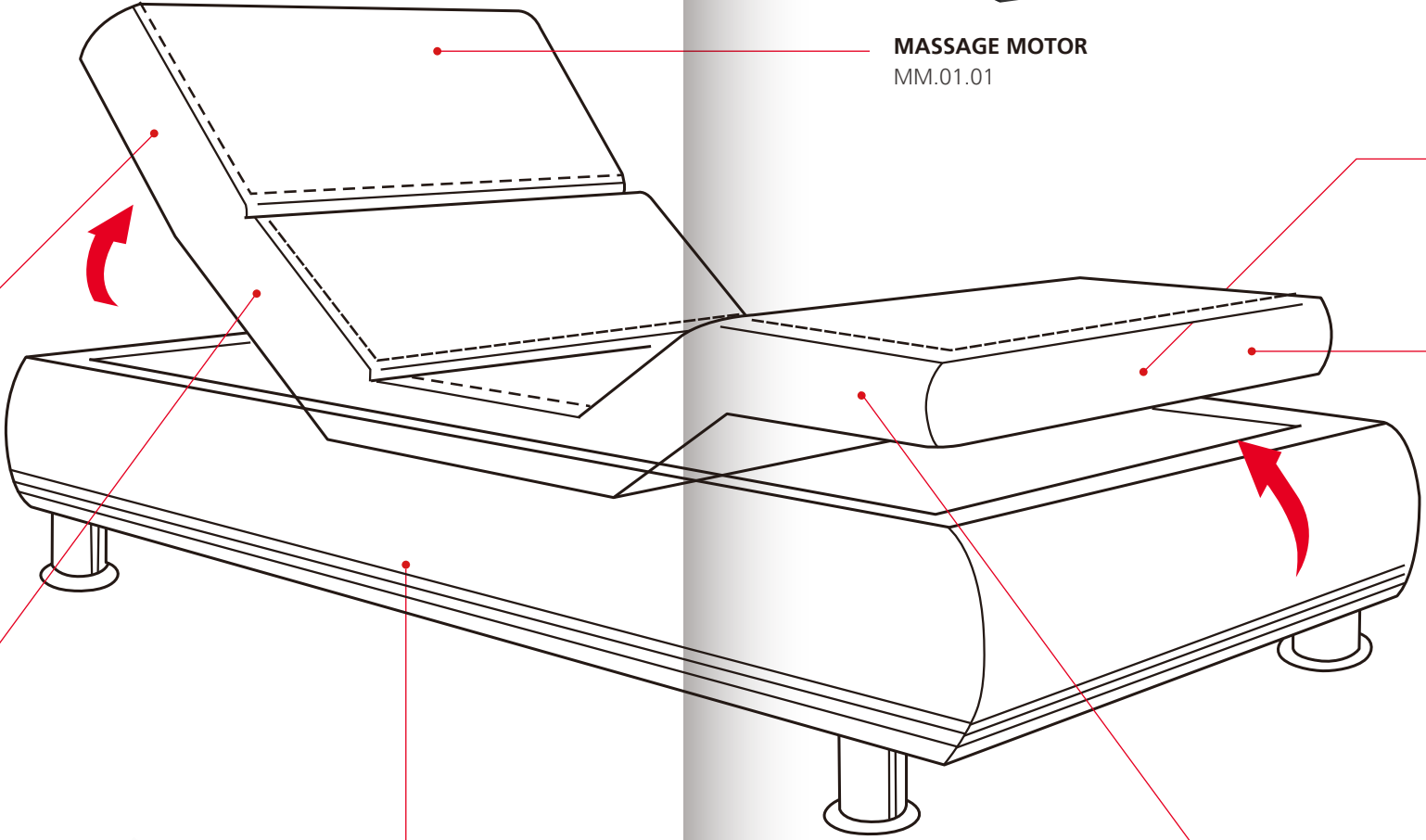





POWERED BY OKIN



Noiseless



Powerful



Stable

JLDQ.19

Actuators



Minimum installation size	Stroke + 150mm
Load capacity	6000N max
Noise	≤50dB
Certifications	UL, FCC, UKCA, CE, CB

JLDQ.19C



Minimum installation size	Stroke + 150mm
Load capacity	6000N max
Noise	≤50dB
Certifications	UL, FCC, UKCA, CE, CB

JLDQ.14B



JLDQ.20



Actuators

Minimum installation size	Stroke + 135mm	Stroke + 135mm
Load capacity	3000N max	4000N max
Noise	≤50dB	≤50dB
Certifications	UL, FCC, IC, UKCA, CE	UL, FCC, UKCA, CE

JLDQ.22



Clevis available in different rotations (0°/45°/90°/135°) and materials (plastic / zinc alloy)

JLDQ.32

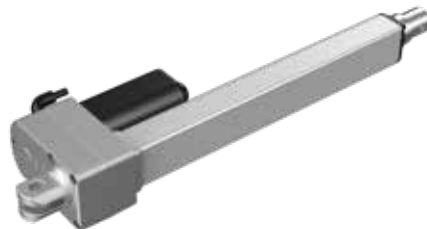

Minimum installation size	Stroke + 150mm	Stroke + 130mm
Load capacity	6000N max	3500N max
Noise	≤50dB	≤50dB
Certifications	UL, FCC, UKCA, CE	CE, UL

JLDQ.34



DA.29



Actuators

Minimum installation size	Stroke + 150mm	Stroke + 168mm
Load capacity	6000N max	8000N max
Noise	≤50dB	≤50dB
Certifications	CE, UL	CE, ICE

Betadrive



Deltadrive



Minimum installation size	Stroke + 157mm	Stroke + 180mm
Load capacity	6000N max	6000N max
Noise	≤50dB	≤50dB
Certifications	UL, CE, CB	UL, CE, CB

DOUBLE DRIVES

- In case of power failure, a 9V battery can be connected to set the bed back to flat position.
- Advanced energy-saving integrated design technology: less than 0.2W standby power consumption.
- Thanks to a built-in SMPS and the wide range voltage input (100-240V AC), OKIMAT 6 can be safely used worldwide.

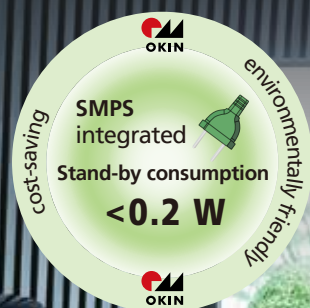

OKIMAT4+2 EPS RF-BT Memory Massage

Double Drives



Input	100-240 V
Stroke range	69mm, 74mm, 87mm
Minimum installation size	581mm
Load capacity	6500N max
Speed	3.2mm/sec max
Optionals	Integrated RF / Memory positions Integrated underbed light Ports for 3rd/4th actuators and massage motors Dedicated MFP port for external LED USB charger and massage motors

OKIMAT6 RF&BT



Input	100-240V
Stroke range	48mm, 69mm, 74mm, 87mm
Minimum installation size	581mm
Load capacity	6000N max
Speed	3.9mm/s max, 4.5mm/sec max
Backup battery	9V

Plug types

CHN, US, JP, EU, UK, AUS plugs available on customer request



Customization

OKIN Provides You With Your Own Handset

- Stylish design
- Easy to use
- Sensitive buttons
- Customizable functions



Our team can help you make your vision become reality - from design to production, we have everything you need to create your own personalized handset.

RF.67

Wireless Handsets



- 7 / 9 / 19 / 21 buttons, controls 2-5 actuators
- White backlight
- One-touch Flat and Zero-G position buttons
- Preset memory positions: 1-6
- Optionals: Flashlight, UBL, Child safety lock, Pair button, Massage

RF.64



- 11 / 20 / 22 buttons, controls 2-5 actuators
- White / Blue backlight
- One-touch Flat and Zero-G position buttons
- Preset memory positions: 1-6
- Side switch to control bed A or bed B or bed A+B
- Optionals: UBL, Child safety lock, Flashlight, Massage

RF.58

Wireless Handsets

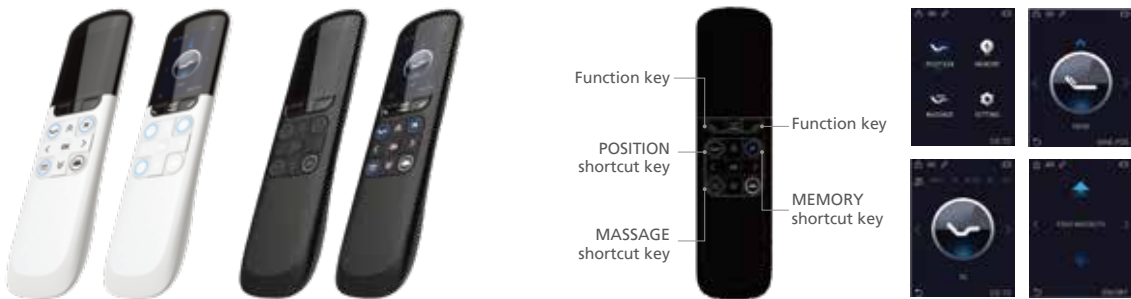

- Color display + 12 buttons, controls 2-5 actuators
- White backlight
- One-touch Flat position button
- Preset memory positions: 1-6
- Optionals: UBL, Child safety lock, Massage

RF.51

Wireless Handsets



- 11 / 19 / 21 buttons, controls 2-5 actuators
- White backlight
- One-touch Flat and Zero-G position buttons
- Preset memory positions: 1-6
- Optionals: Flashlight, UBL, Child safety lock, Pair button, Massage

RF.56



- 11 / 14 / 20 / 24 buttons, controls 2-5 actuators
- White backlight
- One-touch Flat and Zero-G position buttons
- Preset memory positions: 1-6
- Optionals: Flashlight, UBL, Child safety lock, Pair button, Massage

RF.50



- 11 / 17 / 19 / 22 buttons, controls 2-5 actuators
- White backlight
- One-touch Flat and Zero-G position buttons
- Preset memory positions: 1-6
- Optionals: UBL, Child safety lock, Pair button, Massage

RF.34

Wireless Handsets



- 3 / 5 / 7 / 9 buttons, controls 1-4 actuators
- Blue / White Backlight
- One-touch Flat and Zero-G position buttons
- Preset memory positions: 1-6
- Optionals: Flashlight, UBL, Child safety lock, Pair button

RF.28

Wireless Handsets



- 7 / 9 buttons, controls 2-4 actuators
- Blue backlight
- One-touch Flat and Zero-G position buttons
- Preset memory positions: 1-6
- Optionals: Flashlight, UBL, Child safety lock

RF.29



- 11 buttons, controls 2-5 actuators
- No backlight
- One-touch Flat and Zero-G position buttons
- Preset memory positions: 1-6
- Optionals: Flashlight, UBL, Child safety lock, Pair button, Massage

RF.27



- 11 / 19 buttons, controls 2-5 actuators
- Blue backlight
- One-touch Flat and Zero-G position buttons
- Preset memory positions: 1-6
- Optionals: Flashlight, UBL, Child safety lock, Pair button, Massage

Proline



2 / 4 / 6 / 8 buttons, controls 1-3 actuators

Baseline



2 / 6 buttons, controls 1-2 actuators

Wired Handsets

HS.33



6 buttons, controls 2 actuators

Wired Handsets

HS.12



2 / 4 buttons, controls 1-2 actuators

HS.13



2 / 3 / 4 / 5 / 6 / 7 buttons, controls 1-3 actuators

RF ECO SET



2 / 6 buttons, controls 1-2 actuators
Two single beds synchronization with wireless sync

RF LITE SET



2 / 6 buttons, controls 1-2 actuators
Two single beds synchronization with wireless sync
One-touch Flat position button



Integrated
Controls

Bluetooth®

Reliable
Quality

CB.12.20



- 2 actuators, 6 preset memory positions
- Wired and wireless synchronization
- 2.4GHz ISM, RF communication
- Optionals: External Bluetooth®, UBL

CB.12.21



- 2 actuators, 6 preset memory positions
- 1 port for massage motor or underbed light
(2-pin port direct connection)
- Wired synchronization
- RF&BT dual-mode communication, Built-in Bluetooth®
- Optional: Voice control

CB.24.22



- 2 actuators, 6 preset memory positions
- 2 ports for massage motor (2-pin port direct connection)
- Wired synchronization
- RF&BT dual-mode communication, Built-in Bluetooth®
- Reserved MFP port
- Single hall sensor actuators available
- Optionals: UBL, USB charger, Voice control

CB.24.42



- 3-4 actuators, 6 preset memory positions
- 2 ports for massage motor (2-pin port direct connection)
- Wired synchronization
- RF&BT dual-mode communication, Built-in Bluetooth®
- Reserved MFP port
- Optionals: UBL, USB charger, Voice control

CB.24.54



- 4-5 actuators, 6 preset memory positions
- 4 ports for massage motor (2-pin port direct connection)
- Wired synchronization
- RF&BT dual-mode communication, Built-in Bluetooth®
- Reserved MFP port
- Single hall sensor actuators available
- Optionals: UBL, USB charger, Voice control

Control Boxes

POWER SUPPLIES



VI
Energy
Efficiency
Class

Safety
Protection

Multiple
Certifications

Lithium Battery JLDP.11



Output: 20-29.4V/3.0A
Normal capacity: 1800mAh
Maximum discharge current: 5.0A
Overcharge, electric discharge and short circuit protection

Power Supplies

Wall plug SMPS PW.10



Input: 100-240V AC 50Hz~60Hz 2.5A
Output: 29V DC 1.5A / 1.8A / 2.0A
Overvoltage, overcurrent, overheating and short circuit protection

Desktop SMPS PW.20



Input: 100-240V AC 50Hz~60Hz 2.5A
Output: 29V DC 1.8A / 2.0A / 3.0A
Overvoltage, overcurrent, overheating and short circuit protection

Desktop SMPS PW.30



Input: 100-240V AC 50Hz~60Hz 2.5A
Output: 29V DC 1.8A / 2.0A
Overvoltage, overcurrent, overheating and short circuit protection
Back up battery compartment (2*9V batteries)

USB Charger Sockets

● PO.03.04



USB-A + USB-C
USB Input: 5V
USB Output: 5V/2A

● PO.04.02/03



USB-A + USB-C 18W/10W
USB Input: 29V
USB Output: 5V/3A, 9V/2A, 12V/1.5A

● PO.08.02



USB-A + USB-C
USB Input: 5V
USB Output: 5V/2A
Small Size: 65.42×25.42mm

● PO.11.01/02



USB-A + USB-C 20W/10W
USB Input: 29V
USB Output: 5V/2.5A,9V/2A,12V/1.5A

● PO.13.01/02



USB-A + USB-C 18W/10W
USB Input: 29V
USB Output: 5V/3A, 9V/2A, 12V/1.5A

● PO.02.01



USB-A Charging Ports: 2
USB Input: 29V
USB Output: 1*5V/1.0A, 1*5V/2.1A

● PO.02.02



USB-A Charging Ports: 2
USB Input: 5V
USB Output: 5V/2A

● PO.06



USB-A Charging Ports: 2
USB Input: 29V
USB Output: 1*5V/1.0A, 1*5V/2.1A
Thin Type

● PO.08.01



USB-A Charging Ports: 2
USB Input: 5V
USB Output: 5V/2A
Small Size: 65.42×25.42mm

Massage Motor Kits

● MM.01.01



Input: 24-29V DC
Speed: 2200RPM
Works with control box

● JLDQ.9.001



Input: 24-29V DC
Speed: 2240/2800RPM
Works with control box

● MK.01



Rubber mat and ABS support bars
Used to install the massage motor

Underbed LED Light Strips

● FP.03.01



Input: 29V DC
2.1DC Plug / 2*24AWG or 4-pin Plug
Light Color: Warm White (2800-3200k color temperature)

● R5.113



Input: 29V DC
2.1DC Plug / 2*24AWG or 4-pin Plug
Light Color: Warm White (2800-3200k color temperature)
RGB LED Strip (Optional)

● FP.07.03



Easy to install, can be placed on the bed side or the bed leg
Activated by human movement in a dark environment, automatically turns the underbed light on/off
Infrared detection sensor



VOICE CONTROL SYSTEMS

“Flat Position”

“TV Position”

“Hello, Jarvis”

Wired Offline Voice Control FP.08.07

Voice Control Systems



- Plug & play offline voice control, simple to use
- USB-A + USB-C 18W fast charge + wireless charger
- USB output: 5V 3A / 9V 2A / 12V 1.5A
- Wireless charger: 5W
- Emergency stop and flat function

Wireless Offline Voice Control FP.08.08



- Wireless offline voice control
- No cable connection for easier placement near the bed area
- 2.4 GHz RF
- Pairing and emergency stop buttons

Online Voice Control



- Online voice control
- Connection with “Amazon Alexa” devices
- Wi-fi control box needed

Bluetooth Speaker

System Solutions

- Invisible Aesthetics

Ultra-slim design, can be perfectly hidden under the bed, delivering sound right by your pillow. Ideal even for space-limited foldable beds.

- Powerful Sound Field

Dual 20W stereo speakers with professional audio units, offering powerful sound in a small package—rich bass and clear highs.

- Smart Control Convenience

Instant Bluetooth® connection to smartphones or TVs, transforming your bedroom into a private cinema in seconds, perfect for entertainment and promoting better sleep.

- Safety and Durability

Low-voltage DC power supply ensures safety and reliability, providing long-lasting performance.



IOT Platform Access Solution

System Solutions



Tuya IoT Access Solution

Enables smart beds connection to the Tuya IoT platform via a OKIN Wi-Fi dongle. It allows users to create scene linkages and can be controlled via mobile phones, smart screens, smart speakers and other devices. It can also provide customized IoT access services, such as those for Amazon.

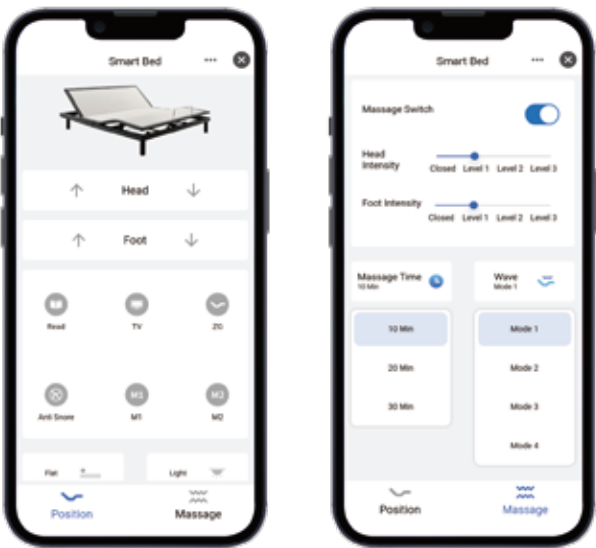

Anti-pinch System

System Solutions

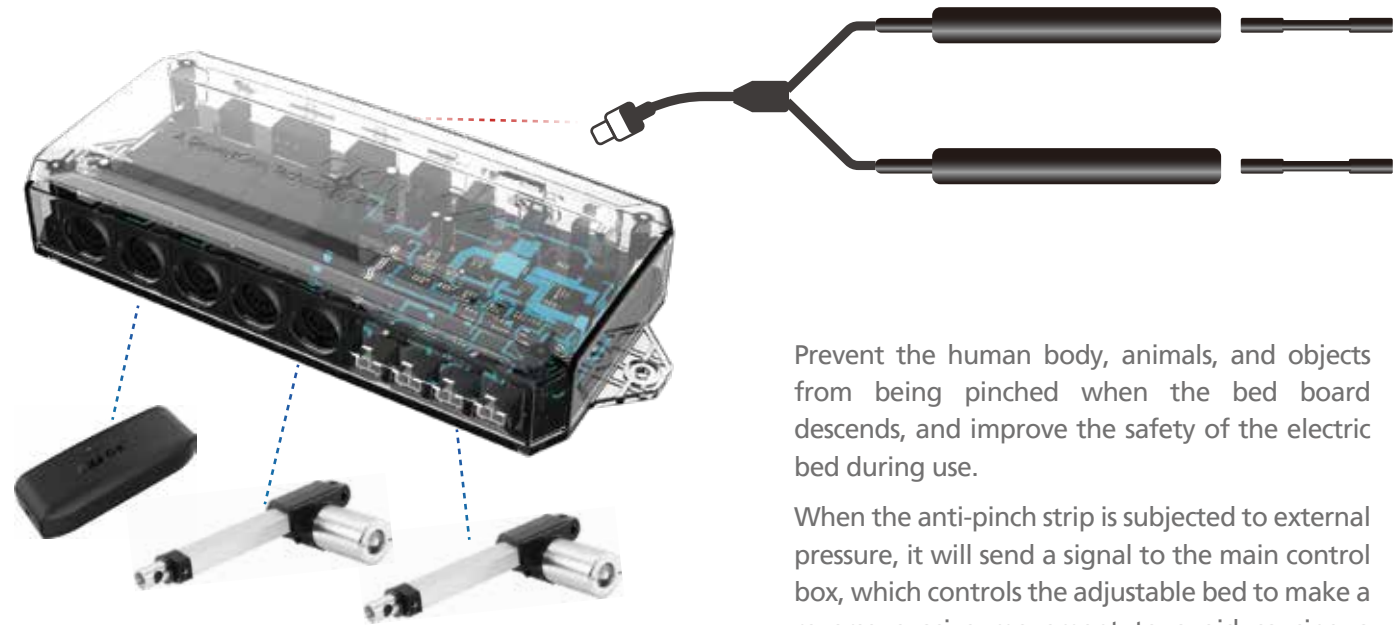

Prevent the human body, animals, and objects from being pinched when the bed board descends, and improve the safety of the electric bed during use.

When the anti-pinch strip is subjected to external pressure, it will send a signal to the main control box, which controls the adjustable bed to make a reverse evasive movement to avoid causing a crushing injury.

Anti-pinch strips installed around the edge of the bed board

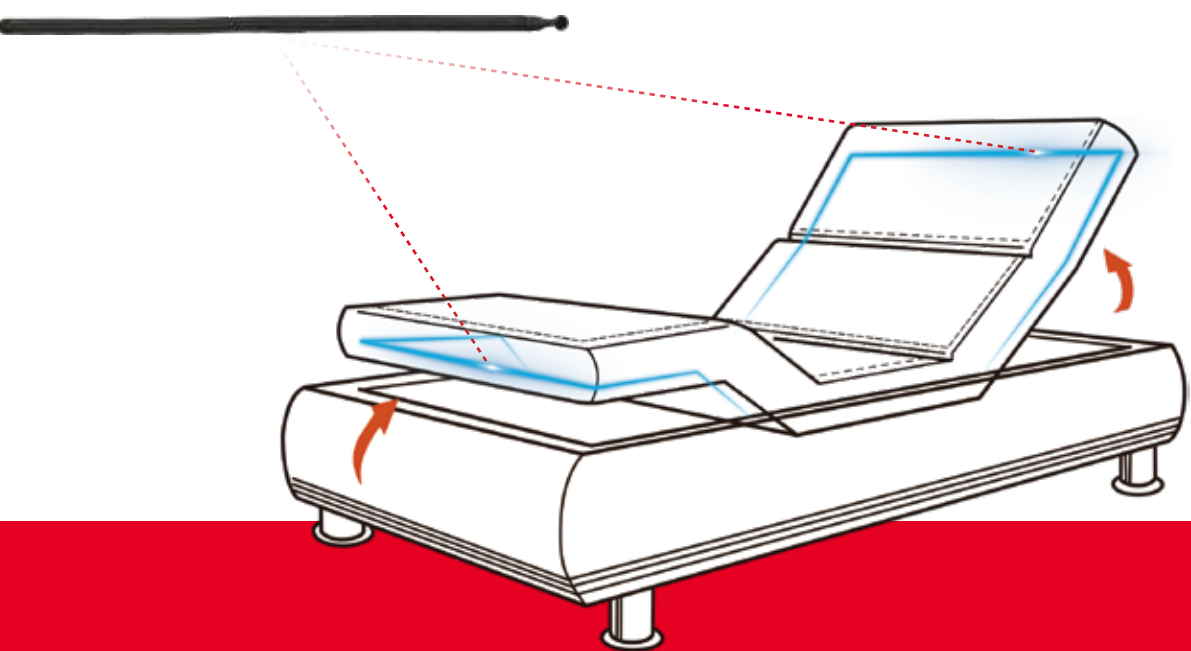

APP Customization

System Solutions

- Adopt Bluetooth® 5.0 technology with lower power consumption, less radiation and faster connection
- Smartphone control with stylish interface design
- Actuator control, lights control, massage control and alarm setup functions
- Customized interface design available
- Support Siri voice control



Personalized custom interface



App Store



Google Play



Huawei App Store



Offline voice control Smart anti-snoring function



- Smart anti-snoring function
- English offline voice control
- Emergency stop (one-click stop)
- Bed control
- White noise
- Wireless pairing



iOS:
Snore Monitor



Android:
Snore Monitor

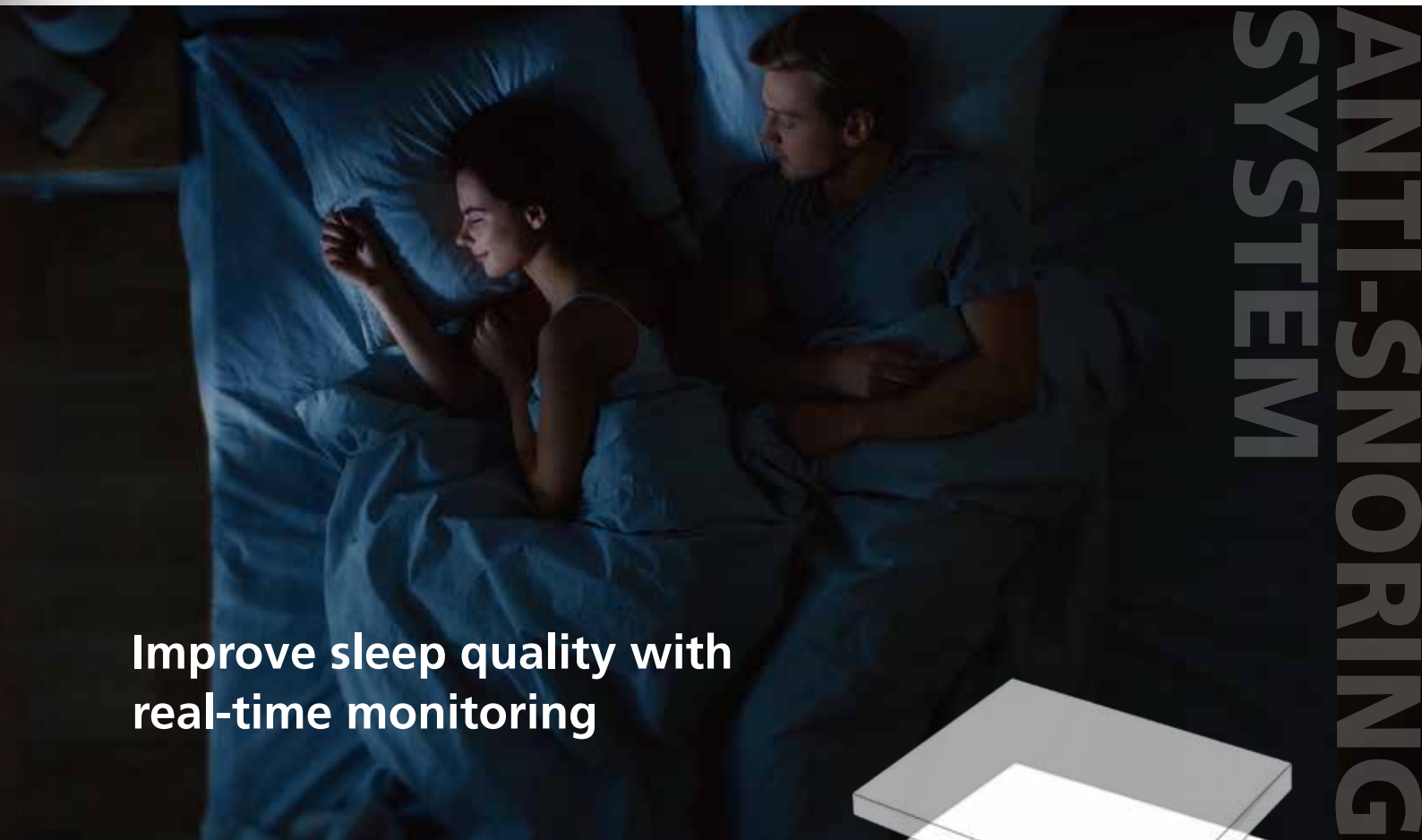
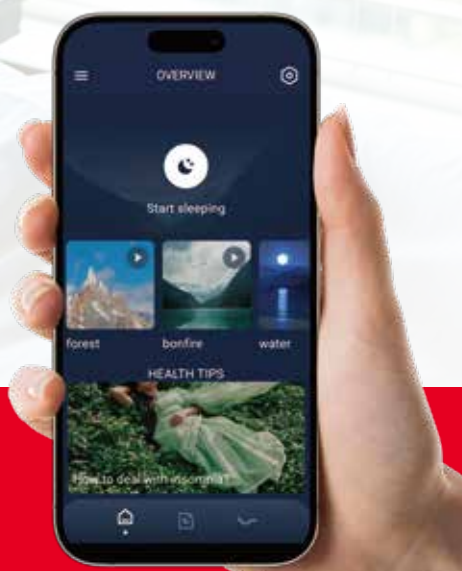

Improve sleep quality with real-time monitoring



- Smart anti-snore function
- Monitor vital signs data in real time
- Sleep report
- Sleep music
- Smart bed control
- Smart wake-up function

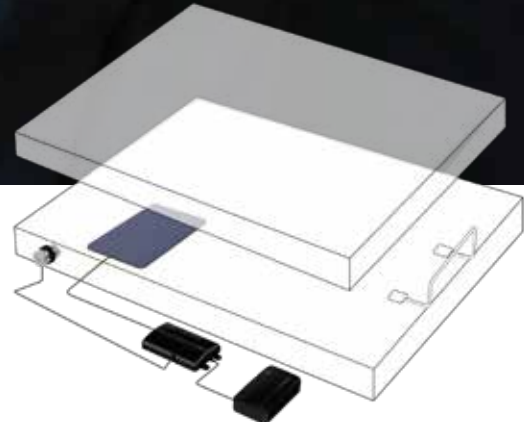

Available for
iOS devices



Available for
Android devices
(Other regions)



Available for
Android devices
(Chinese mainland)



China Jiaxing

Add: No.1507 Taoyuan Road, Gaozhao Subdistrict, Xiuzhou Development Zone, Jiaxing, Zhejiang, China 314031
Service Hotline: +86-400-887-8573
Tel: +86-(0)573-8228-1028
E-mail: info@dewertokin.com
Web: www.dewertokin.com

China Huizhou

Add: Building C6, Zhantao Industrial Zone, Weibu Village, Qiuchang Town, Huiyang District, Huizhou, Guangdong, China
E-mail: info@dewertokin.com

China Taiwan

Phoenix Mecano Hong Kong Limited Taiwan Branch
Add: Room 4E-12, No.5, Hsin-Yi Road, Sec. 5, 11011 Taipei, Taiwan, China
Contact: Allen Wang
Phone: +886 2 27252582
E-mail: allen@pmtwn.com.tw

Korea

Add: No. 506, Bomb Building, 617-3, Gajeong-dong, Seo-gu, Incheon, Korea.
Zip Code: 22731
Contact: Amos An
Mobile: +82-10-6865-0599
E-mail: amos.an@dewertokin.com

Japan

Add: 52 Saiwai-Cho 420-0067 Shizuoka-City
Contact: JR Piao
Mobile: +81-90-6507-0205
E-mail: jr.piao@dewertokin.com
Web: www.dewertokin.com/ja/

Australia

Add: 64 Butler Way, Tullamarine, Victoria, Australia, 3043
Tel: +61 (3) 9338 56 99
Fax: +61 (3) 9338 53 99
E-mail: info@phoenix-mecano.com.au
Web: www.phoenix-mecano.com.au

Germany

DewertOkin GmbH
Weststrasse 1
32278 Kirchleugern
Deutschland / Germany
Tel: +49 5223 979 0
Fax: +49 5223 751 82
E-mail: info@dewertokin.de
Web: www.dewertokin.com

Vietnam

Lo H5-2(khu B1), duong D9, khu cong nghiep rach bap, xa an dien, thi xa ben cat, tinh binh duong, Vietnam
Contacts: Josiah Xia
Mobile: +84 0913922780
Email: Josiah.Xia@dewertokin.com

Malaysia / India

Singapore / Thailand

Indonesia

Add: No. 22A-1, Blok 22A, Level1, Empire Galleri, Jalan Empayar/KU1 off Persiaran Sultan Ibrahim, 41150 Klang, Selangor, Malaysia
Zip Code: 41150
Contact: Ngkian Seng
Mobile: +60 193150628
E-mail: ngkianseng@dewertokin.com

United States

Okin America INC.
Add: 291 CDF Blvd Shannon, MS 38868
Tel: +1 662-566-1000
E-mail: orders.okin@okinamerica.com
Web: www.okinamerica.com

Brazil

DewertOkin Latin America
Address: Av. Prof. Alceu Maynard de Araujo, 185, São Paulo, SP
Zip Code: 04626-160
Contact: Adriana Shinzato
E-mail: vendas@dewertokin.com.br
Tel: +55.11.56434190
Web: www.dewertokin.com.br

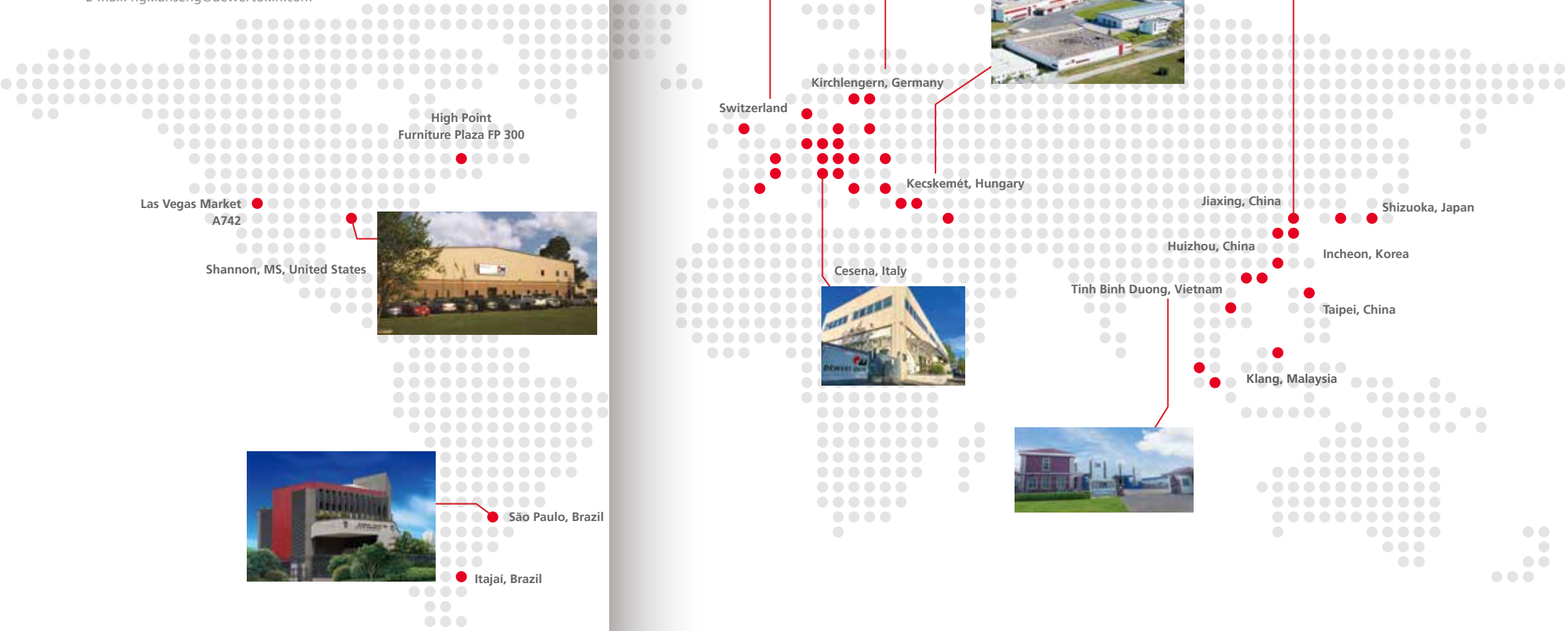

OKIN Global Service Around the World

Over 40 years of experience.



Follow us: DewertOkin

